

ROOF SECTION 8 - EXISTING ROOF ASSEMBLY

- ER2
- 2-PLY SBS MEMBRANE
- 1/4" FIBREBOARD
- TAPERED EPS INSULATION
- 3" POLYISO INSULATION
- KRAFT VAPOUR RETARDER
- 1/2" DRYWALL
- STEEL DECK

ROOF SECTION 8 - NEW ROOF ASSEMBLY

- R2
- NEW 60MIL TREMCO KEE FLEECEBACK MEMBRANE - ADHERED
- NEW 1/2" DENSDECK PRIME - ADHERED
- NEW 2" NON-ORGANIC POLYISO INSULATION - ADHERED
- 1.5% TAPERED TYPE II EPS INSULATION - ADHERED
- NEW SELF-ADHERING VAPOUR RETARDER MEMBRANE
- NEW 1/2" DENSDECK PRIME SHEATHING - ADHERED
- EXISTING STEEL DECK



CONSULTANT:



CLIENT:



PROJECT NAME:

**FRANK JAMESON
COMMUNITY CENTRE**
810 - 6th Avenue
Ladysmith, BC
V9G 1A2

LEGEND:

- ROOF DRAIN WITH 4' X 4' SUMP
- PLUMBING VENT
- CURBED PLUMBING VENT
- ROOFTOP UNIT
- MAKE UP AIR UNIT
- AC UNIT
- MECHANICAL UNIT ON SLEEPERS
- CURBED VENT
- CURBED CHIMNEY
- CURB WITH METAL BIRDHOUSE FLASHING
- EXHAUST FAN
- ROOF HATCH
- PRIMARY SCUPPER DRAIN
- EMERGENCY OVERFLOW SCUPPER
- GUM BOX
- ROOF ANCHOR
- CONCRETE PAVER
- MAN DOOR
- GAS LINE
- ELECTRICAL LINE
- DRAWING NOTE

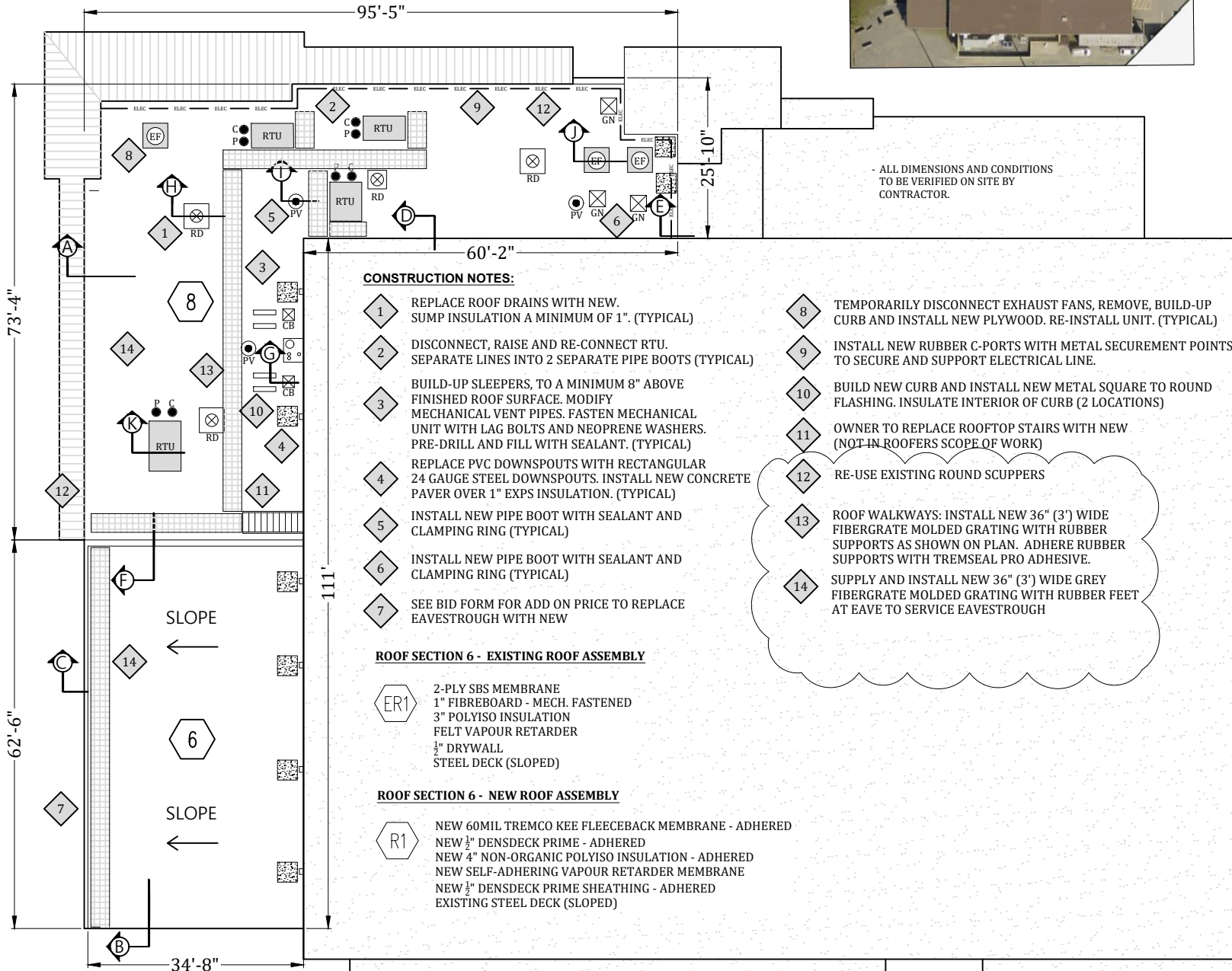

ALL DIMENSIONS AND CONDITIONS TO BE VERIFIED ON SITE BY CONTRACTOR.

CONSTRUCTION NOTES:

- 1 REPLACE ROOF DRAINS WITH NEW. SUMP INSULATION A MINIMUM OF 1". (TYPICAL)
- 2 DISCONNECT, RAISE AND RE-CONNECT RTU. SEPARATE LINES INTO 2 SEPARATE PIPE BOOTS (TYPICAL)
- 3 BUILD-UP SLEEPERS, TO A MINIMUM 8" ABOVE FINISHED ROOF SURFACE. MODIFY MECHANICAL VENT PIPES. FASTEN MECHANICAL UNIT WITH LAG BOLTS AND NEOPRENE WASHERS. PRE-DRILL AND FILL WITH SEALANT. (TYPICAL)
- 4 REPLACE PVC DOWNSPOUTS WITH RECTANGULAR 24 GAUGE STEEL DOWNSPOUTS. INSTALL NEW CONCRETE PAVER OVER 1" EXPS INSULATION. (TYPICAL)
- 5 INSTALL NEW PIPE BOOT WITH SEALANT AND CLAMPING RING (TYPICAL)
- 6 INSTALL NEW PIPE BOOT WITH SEALANT AND CLAMPING RING (TYPICAL)
- 7 SEE BID FORM FOR ADD ON PRICE TO REPLACE EAVESTROUGH WITH NEW
- 8 TEMPORARILY DISCONNECT EXHAUST FANS, REMOVE, BUILD-UP CURB AND INSTALL NEW PLYWOOD. RE-INSTALL UNIT. (TYPICAL)
- 9 INSTALL NEW RUBBER C-PORTS WITH METAL SECUREMENT POINTS TO SECURE AND SUPPORT ELECTRICAL LINE.
- 10 BUILD NEW CURB AND INSTALL NEW METAL SQUARE TO ROUND FLASHING. INSULATE INTERIOR OF CURB (2 LOCATIONS)
- 11 OWNER TO REPLACE ROOFTOP STAIRS WITH NEW (NOT IN ROOFERS SCOPE OF WORK)
- 12 RE-USE EXISTING ROUND SCUPPERS
- 13 ROOF WALKWAYS: INSTALL NEW 36" (3') WIDE FIBERGRATE MOLDED GRATING WITH RUBBER SUPPORTS AS SHOWN ON PLAN. ADHERE RUBBER SUPPORTS WITH TREMSEAL PRO ADHESIVE.
- 14 SUPPLY AND INSTALL NEW 36" (3') WIDE GREY FIBERGRATE MOLDED GRATING WITH RUBBER FEET AT EAVE TO SERVICE EAVESTROUGH

ROOF SECTION 6 - EXISTING ROOF ASSEMBLY

- ER1
- 2-PLY SBS MEMBRANE
- 1" FIBREBOARD - MECH. FASTENED
- 3" POLYISO INSULATION
- FELT VAPOUR RETARDER
- 1/2" DRYWALL
- STEEL DECK (SLOPED)

ROOF SECTION 6 - NEW ROOF ASSEMBLY

- R1
- NEW 60MIL TREMCO KEE FLEECEBACK MEMBRANE - ADHERED
- NEW 1/2" DENSDECK PRIME - ADHERED
- NEW 4" NON-ORGANIC POLYISO INSULATION - ADHERED
- NEW SELF-ADHERING VAPOUR RETARDER MEMBRANE
- NEW 1/2" DENSDECK PRIME SHEATHING - ADHERED
- EXISTING STEEL DECK (SLOPED)

DATE:	JUN.10.2024
FILE NO.:	24-058
DRAWN BY:	J.S.
SCALE:	N.T.S.
DWG. TITLE	DWG. NO.: